

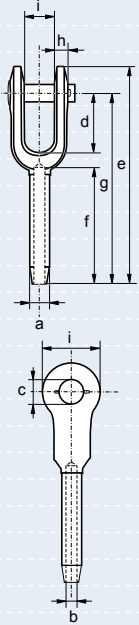

Green Pin® Swage Sockets open type

- **Material** : drop forged steel C-1035
- **Finish** : self colour



diameter rope	diameter outside	diameter inside	diameter pin	length	length	length	length	thickness	width inside	width eye	weight each
mm	a	b	c	d	e	f	g	h	i	j	kg
6	13	7	17	38	121	54	102	8	17	35	0.25
8	20	9	21	44	159	81	135	10	21	41	0.50
10	20	12	21	44	159	81	135	10	21	41	0.49
11	25	12	25	51	198	108	169	13	25	51	1.04
13	25	14	25	51	198	108	169	13	25	51	1.02
14	32	15	30	57	243	135	206	16	32	63	2.09
16	32	17	30	57	243	135	206	16	32	63	2.04
19	39	20	35	70	297	162	254	19	38	76	3.54
22	43	24	41	83	346	189	295	23	44	86	5.31
25	50	27	51	95	397	216	340	26	51	102	8.07
29	57	30	57	108	444	243	381	30	57	114	13.50
32	64	34	64	121	494	270	419	30	63	127	16.30
35	71	37	64	133	540	297	460	33	63	133	21.30

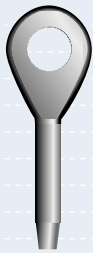

Green Pin® Swage Sockets closed type

- **Material** : drop forged steel C-1035
- **Finish** : self colour

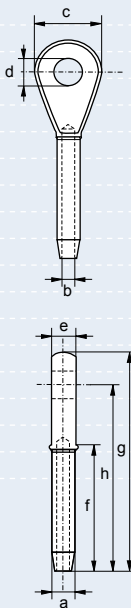

diameter rope	diameter outside	diameter inside	diameter	diameter	thickness	length	length	length	weight each
mm	a	b	c	d	e	f	g	h	kg
6	13	7	37	19	13	54	111	89	0.15
8	20	9	43	22	17	81	140	114	0.36
10	20	12	43	22	17	81	140	114	0.35
11	25	12	51	27	22	108	176	146	0.66
13	25	14	51	27	22	108	176	146	0.63
14	32	15	63	32	29	135	222	184	1.26
16	32	17	63	32	29	135	222	184	1.25
19	39	20	76	37	33	162	264	219	2.27
22	43	24	89	43	38	189	308	257	3.40
25	50	27	102	52	44	216	349	292	5.08
29	57	30	114	59	51	243	387	324	7.17
32	64	34	127	65	57	270	438	365	10.40
35	71	37	133	65	57	297	479	400	14.10